



# ITT

## ROBOT PUMPS

### Turbotex Pump

### RT4042DZ

### 50 Hz

Turbotex pumps are auto cleaning solids handling pumps. The impeller leading edge is almost parallel with the direction of the flow and leads into the impeller passage. Turbotex pumps are first choice for raw unscreened sewage as well as for lightly contaminated liquids.

#### Pump

solids passage : 100 mm  
 suction diameter : 150 mm  
 discharge diameter : 150 mm  
 impeller diameter : 245-210 mm  
 recommended minimum flow : 13 l/s (47 m<sup>3</sup>/h)

#### Motor

rated shaft power : 12.0 kW  
 rated electrical power : 15.1 kW  
 mains : 50 Hz - 3 phase  
 nominal speed : 1450 rpm  
 motor efficiency : 75%  
 rated power factor (cos phi) : 0.88  
 degree of protection : IP 68  
 isolation class : F (155 °C)  
 max. water temperature : 40 °C  
 (higher temp. on request)  
 standard cable length : 10 m

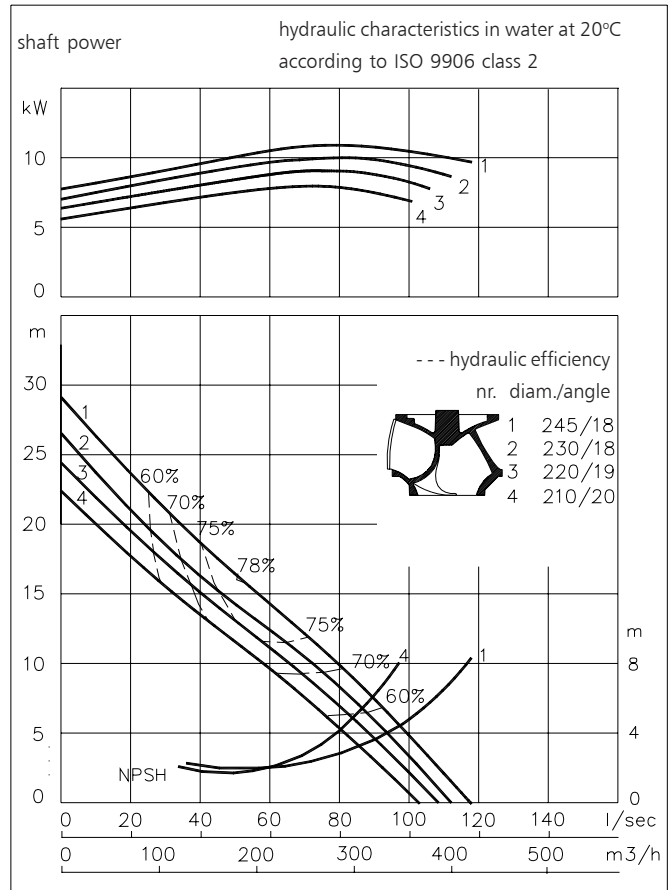

#### Materials

motor housing : 1  
 seal housing : 1  
 volute : 1  
 impeller : 2 7  
 shaft : 3 5  
 bolts : 4 5  
 cooling jacket : 5  
 elastomers : 8+9 10  
 electrical cable : 9  
 seal lubrication : oil  
 pump seal : silicon carbide-ceramic  
 motor seal : carbon - ceramic  
 primer : Alkyd primer  
 top coating : Two component high-build polyurethane coating

1	cast iron	EN-GJL-250
2	sg cast iron	EN-GJS-400-15
3	stainless steel 431	X20 CrNi 17 2
4	stainless steel 304	X5 CrNi 18 10
5	stainless steel 316	X5 CrNiMo 17 12 2
6	stainless steel 329	X4 CrNiMoN 27 5 2
7	wear resistant sg iron	HB 500
8	nitrile	(NBR)
9	neoprene	(CR)
10	viton	(FPM)

[www.ittwwwalphen.com](http://www.ittwwwalphen.com)

*Engineered for life*



### Installation options

### RT4042DZ

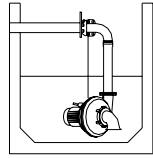

**H**

Header coupling:  
Type HK150

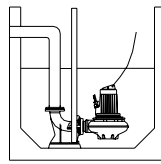

**V**

Guide bar coupling:  
Type V150N

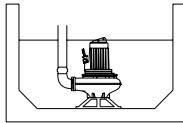

**F**

Freestanding:  
With support and  
150mm hose adapter

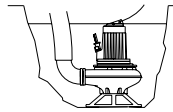

**T**

Transportable:  
With support and  
150mm hose adapter

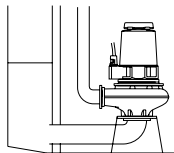

**A**

Immersible:  
vertical or horizontal  
with cooling system and  
support.  
Discharge: 150mm  
Suction: 150mm

The motor is cooled by the surrounding water.  
With cooling version the motor can run continuously above the waterlevel

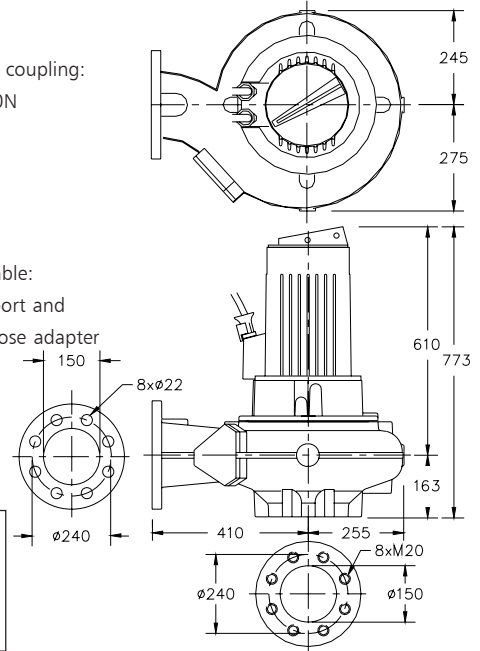

### Versions

**B Basic**

Weight:

205 kg

**C Version with cooling system**

Internal or external circulation  
(external cooling water min. flow 0.15 l/s)

217 kg

### Optional:

**Thermoswitches** in motorwindings  
Standard for version with cooling system.

**Flexible protective sheathing for cable**  
(AISI 316)

**Water detector in motor and oil housing**

### Motor connection details

voltage [V]*	rated current[A]	number of cables x number of cores x cross section [mm²]			
				with waterdetector and/or thermoswitches	
		DOL-start	YD-start	DOL-start	YD-start
220	47.5	1x4x10	2x4x4	1x4x10 + 1x4x2.5	not possible
380	27.5	1x4x4	1x7x2.5	1x4x4 + 1x4x2.5	1x7x2.5 + 1x4x2.5
400	26.1	1x4x4	1x7x1.5	1x4x4 + 1x4x2.5	1x10x1.5
415	25.2	1x4x4	1x7x1.5	1x4x4 + 1x4x2.5	1x10x1.5
500	20.9	1x4x4	1x7x1.5	1x4x4 + 1x4x2.5	1x10x1.5

starting current DOL start

: 5.0 x rated current

\*other voltages on request

starting current YD-start

: 1.7 x rated current

We reserve the right to alter specifications without prior notice.