



ITT

ROBOT PUMPS

Turbotex Pump

RT4040FE

50 Hz

Turbotex pumps are auto cleaning solids handling pumps. The impeller leading edge is almost parallel with the direction of the flow and leads into the impeller passage. Turbotex pumps are first choice for raw unscreened sewage as well as for lightly contaminated liquids.

Pump

solids passage : 100 mm
 suction diameter : 120 mm
 discharge diameter : 100 mm
 impeller diameter : 226 -165 mm
 recommended minimum flow : 6 l/s (21 m³/h)

Motor

rated shaft power : 2.4 kW
 rated electrical power : 3.2 kW
 mains : 50 Hz - 3 phase
 nominal speed : 960 rpm
 motor efficiency : 75%
 rated power factor (cos phi) : 0.81
 degree of protection : IP 68
 isolation class : H (180 °C)
 max. water temperature : 40 °C
 (higher temp. on request)
 standard cable length : 10 m

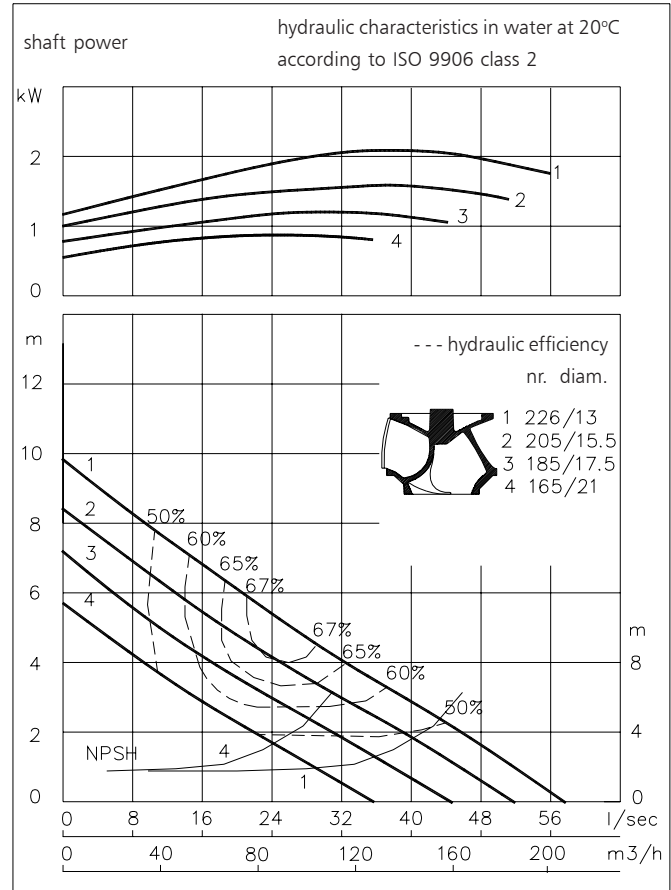

Materials

motor housing : 1
 seal housing : 1
 volute : 1
 impeller : 2 7
 shaft : 3 5
 bolts : 4 5
 cooling jacket : 5
 elastomers : 8+9 10
 electrical cable : 9
 seal lubrication : oil
 pump seal : silicon carbide-silicon carbide
 motor seal : silicon carbide-silicon carbide
 primer : Alkyd primer
 top coating : Two component high-build polyurethane coating

1	cast iron	EN-GJL-250
2	sg cast iron	EN-GJS-400-15
3	stainless steel 431	X20 CrNi 17 2
4	stainless steel 304	X5 CrNi 18 10
5	stainless steel 316	X5 CrNiMo 17 12 2
6	stainless steel 329	X4 CrNiMoN 27 5 2
7	wear resistant sg iron	HB 500
8	nitrile	(NBR)
9	neoprene	(CR)
10	viton	(FPM)

www.robotpumps.com

Engineered for life



ITT

ROBOT PUMPS

Installation options

RT4040FE

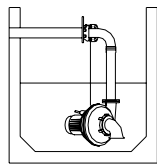

H
Header coupling:
Type HK100

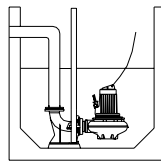

V
Guide bar coupling:
Type V100

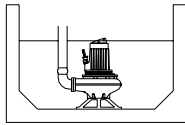
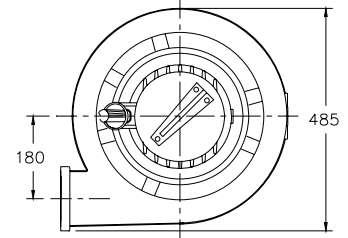

F
Freestanding:
With support and
100 mm hose adapter

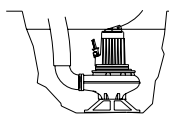

T
Transportable:
With support and
100 mm hose adapter

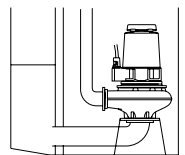

A
Immersible:
vertical or horizontal
with cooling system and
support.
Discharge: 100 mm
Suction: 125 mm

The motor is cooled by the surrounding water.
With cooling version the motor can run continuously above the waterlevel

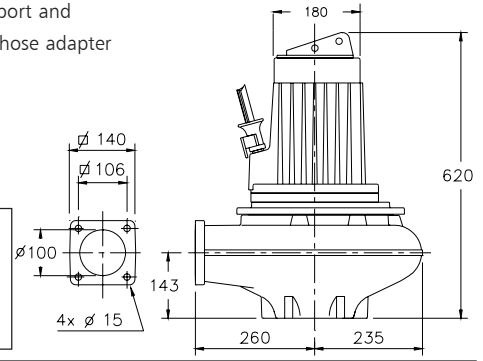

Versions

B Basic

Weight:

111 kg

C Version with cooling system

Internal or external circulation
(external cooling water min. flow 0.15 l/s)

126 kg

Optional:

Thermoswitches in motorwindings
Standard for version with cooling system.

Flexible protective sheathing for cable
(AISI 316)

Water detector in motor and oil housing

For explosion proof version, see RT4040FH

Motor connection details

voltage [V]*	rated current[A]	number of cables x number of cores x cross section [mm²]					
		DOL-start	YD-start	with waterdetector and/or thermoswitches			
				DOL- start	YD-start		
220	10.4	1x4x2.5	1x7x1.5	1x7x1.5	1x10x1.5		
380	6.0	1x4x2.5	1x7x1.5	1x7x1.5	1x10x1.5		
400	5.7	1x4x2.5	1x7x1.5	1x7x1.5	1x10x1.5		
415	5.5	1x4x2.5	1x7x1.5	1x7x1.5	1x10x1.5		
500	4.6	1x4x2.5	1x7x1.5	1x7x1.5	1x10x1.5		

starting current DOL start : 6.4 x rated current

starting current YD-start : 2.1 x rated current

*other voltages on request

We reserve the right to alter specifications without prior notice.