



Turbotex Pump

RT2031DG

60 c/s

Turbotex pumps are auto cleaning solids handling pumps. The impeller leading edge is almost parallel with the direction of the flow and leads into the impeller passage. Turbotex pumps are first choice for raw unscreened sewage as well as for lightly contaminated liquids.

Pump

solids passage : 3 1/4"
 suction diameter : 4 1/4"
 discharge diameter : 4"
 impeller diameter : 175 - 145
 recommended minimum flow : 95 USGPM

Motor

rated horse power : 5.4 hp
 rated electrical power : 5.2 kW
 rated kVA : 6.1 kVA
 mains : 60 c/s - 3 phase
 speed : 1750 rpm
 rated efficiency : 77%
 rated power factor (cos phi) : 0.85
 degree of protection : IP 68
 isolation class : F (311 °F)
 max. water temperature : 104 °F
 (higher temperatures on request)
 standard cable length : 33 ft
 max. submersion depth : 66 ft

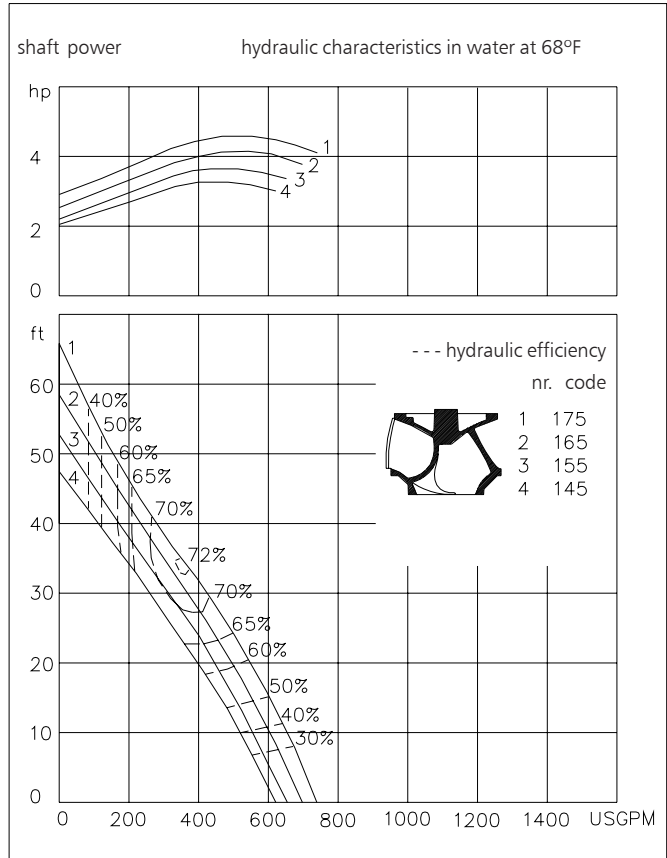

15.9 USGPM = 1 l/s 1 hp = 0.736 kW 1 ft = 0.3 m 1 lb = 0.45 kg

Materials

motor housing : 1
 seal housing : 1
 volute : 1
 impeller : 2 7
 shaft : 3 5
 bolts : 4 5

elastomers : 8+9 10
 electrical cable : 9
 seal lubrication : oil
 pump seal : silicon carbide-silicon carbide
 motor seal : carbon-silicon carbide
 primer : Alkyd primer
 top coating : Two component high-build polyurethane coating

1	cast iron	ASTM A-48 Cl.35
2	sg cast iron	ASTM A445 Gr.60-46-18
3	stainless steel	AISI 431
4	stainless steel	AISI 304
5	stainless steel	AISI 316
6	bronze	ASTM B 145 Gr. 4a
7	wear resistant sg iron	HB500
8	nitrile	(NBR)
9	neoprene	(CR)
10	viton	(FPM)



ITT

ROBOT PUMPS

Installation options

RT2031DG

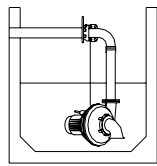

H
Header coupling:
Type HK100

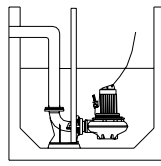

V
Guide bar coupling:
Type V100

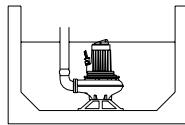

F
Freestanding:
With support and
4" hose adapter or
NPT threaded connection

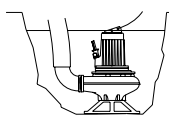

T
Portable:
With support and
4" hose adapter or
NPT threaded connection

The motor is cooled by the surrounding water.

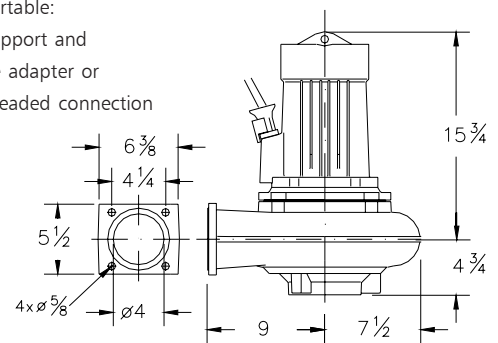
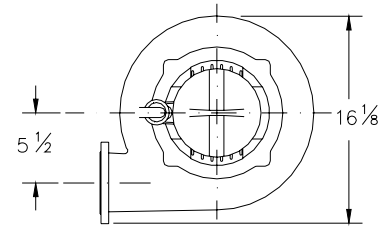

Versions

Weight

B Basic version

154 lbs

Optional:

Thermoswitches in motorwindings.

Flexible protective sheathing for cable
(AISI 316)

Water detector in motor and oil housing

For flameproof version and version with cooling option, see RT4031DG

Motor connection details

voltage [V]*	rated current [A]	electrical cable size					
				with waterdetector and/or thermoswitches			
		DOL-start	YD-start	DOL- start	YD-start		
220	16.0	1xAWG 12/4	1xAWG 16/7	-	1xAWG 16/10		
380	9.3	1xAWG 12/4	1xAWG 16/7	1xAWG 16/7	1xAWG 16/10		
440	8.1	1xAWG 12/4	1xAWG 16/7	1xAWG 16/7	1xAWG 16/10		
460	7.7	1xAWG 12/4	1xAWG 16/7	1xAWG 16/7	1xAWG 16/10		
575	6.1	1xAWG 12/4	1xAWG 16/7	1xAWG 16/7	1xAWG 16/10		

starting current DOL start : 4.3 x rated current

* other voltages on request

starting current YD-start : 1.4 x rated current

We reserve the right to alter specifications without prior notice.