



# ITT

## ROBOT PUMPS

### Dry installed stainless steel vortex pump

### BW2042

The dry installed stainless steel vortex pumps are designed to pump a wide variety of solids contaminated liquids. They are used for sewage and other waste water applications. The pump can be used in aggressive applications pH = 1-13. Standard elastomers are in FPM (Viton).

solids passage : 100 mm **50 Hz**  
 discharge flange : NW 100  
 suction flange : NW 125  
 impeller diameter : 252-200 mm  
 recommended min. flow : 6 l/s (21 m<sup>3</sup>/h)

hydraulic characteristics in clean cold water according to ISO 9906 grade 2

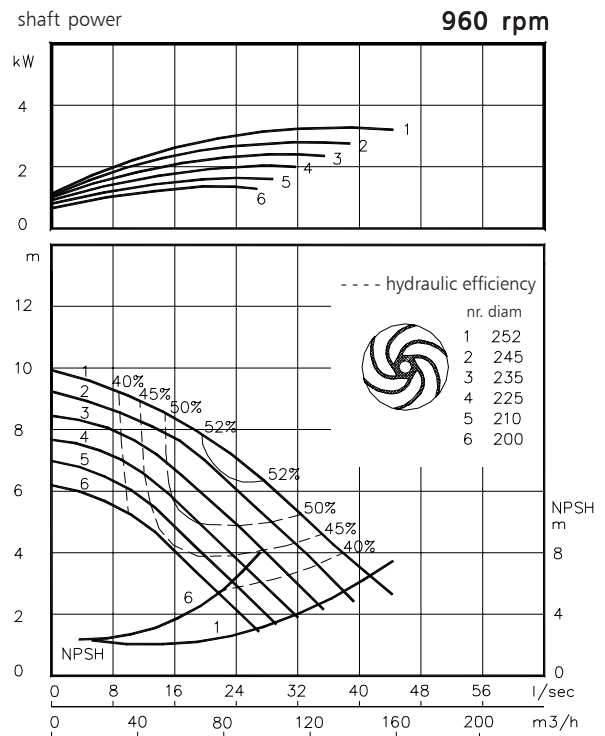
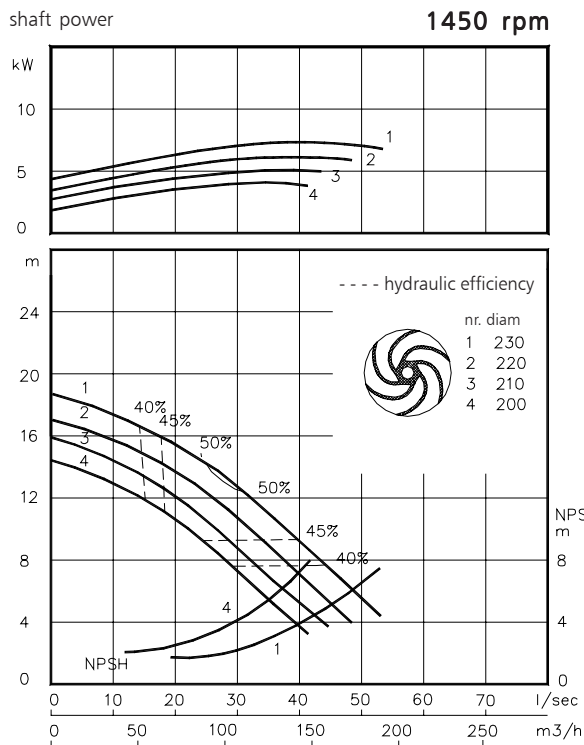

| Available electric motors<br>Degree of protection IP55 |     |       |
|--|-----|-------|
| Class  | kW  | [rpm] |
| IEC 100L   | 1.5 | 960   |
|  | 2.2 | 1450  |
|  | 3.0 | 1450  |
| IEC 112M   | 2.2 | 960   |
|  | 4.0 | 1450  |
| IEC 132S   | 3.0 | 960   |
|  | 5.5 | 1450  |
| IEC 132M   | 4.0 | 960   |
|  | 5.5 | 960   |
|  | 7.5 | 1450  |

[www.robotpumps.com](http://www.robotpumps.com)

*Engineered for life*



### Installation options

### BW2042

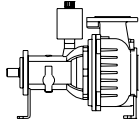

#### H

Horizontal installation:  
Bare shaft

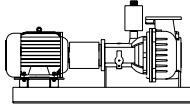

#### HM

Horizontal installation:  
With foundation plate  
and electric motor.

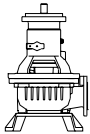

#### V

Vertical installation:  
Bare shaft

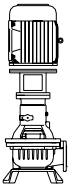

#### VM

Vertical installation:  
With support and electric  
motor.

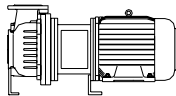

#### HS

Short coupled:  
Horizontal installation.

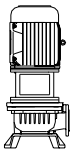

#### VS

Short coupled:  
Vertical installation.

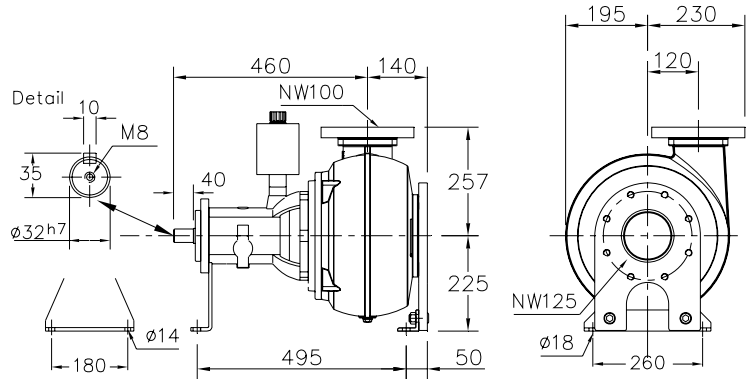

#### Flange connections

|           | Standard           |                 |
|-----------|--------------------|-----------------|
|           | DIN 2501 PN10/PN16 |                 |
|           | p.c.d.             | Number of holes |
| Discharge | NW 100 180         | 8x ø19          |
| Suction   | NW 125 210         | 8x M16          |

Weight (H version): 95 kg.

**Optional:**  
- seal flushing

*Other options and materials upon request*

### Materials

|                  |  |
|------------------|--|
| sealhousing      | : 5  |
| pump casing      | : 5  |
| impeller         | : 5 6  |
| pump shaft       | : 5  |
| bearing housing  | : 1  |
| bolts            | : 4+5  |
| elastomer        | : 10   |
| seal lubrication | : oil  |
| pump seal        | : silicon carbide-silicon carbide                |
| secondary seal   | : 1 radial lipseal                               |
| primer           | : alkyd primer                                   |
| top coating      | : two components high-build polyurethane coating |

|    |                        |                   |
|----|------------------------|-------------------|
| 1  | cast iron              | EN-GJL-250        |
| 2  | sg cast iron           | EN-GJS-400-15     |
| 3  | stainless steel 431    | X20 CrNi 17 2     |
| 4  | stainless steel 304    | X5 CrNi 18 10     |
| 5  | stainless steel 316    | X5 CrNiMo 17 12 2 |
| 6  | stainless steel 329    | X4 CrNiMoN 27 5 2 |
| 7  | wear resistant sg iron | HB 500            |
| 8  | nitrile                | (NBR)             |
| 9  | neoprene               | (CR)              |
| 10 | viton                  | (FPM)             |

We reserve the right to alter specifications without prior notice.