



# ITT

## ROBOT PUMPS

### Slurry Pump

### RD6141LI

### 50 Hz

Vortex impeller pump in wear resistant Nihard 4 for reliable transport of highly abrasive solids in high concentrations.

#### Pump

solids passage : 100 mm  
 solids passage with agitator : 50 mm  
 suction diameter : 145 mm  
 discharge diameter : 150 mm  
 impeller diameter : 295 mm  
 recommended minimum flow : 13 l/s (47 m<sup>3</sup>/h)

#### Motor

rated shaft power : 34.0 kW  
 rated electrical power : 39.5 kW  
 mains : 50 Hz - 3 phase  
 nominal speed : 1450 rpm  
 rated efficiency : 86 %  
 rated power factor (cos phi) : 0.86  
 degree of protection : IP 68  
 isolation class : F (155 °C)  
 max. water temperature : 40 °C  
 (higher temperatures on request)  
 standard cable length version K/E : 20 m  
 standard cable length version B : 10m

#### Materials

motor housing : 1  
 seal housing : 7  
 volute : 7  
 hose/flange adapter : 7  
 impeller : 7  
 agitator : 7  
 shaft : 3 5  
 bolts : 4 5  
 cooling jacket : 4  
 elastomers : 8+9 10  
 electrical cable : 9  
 seal lubrication : oil  
 pump seal : silicon carbide-ceramic  
 motor seal : carbon-ceramic  
 primer : Alkyd primer  
 top coating : Two component high-build polyurethane coating

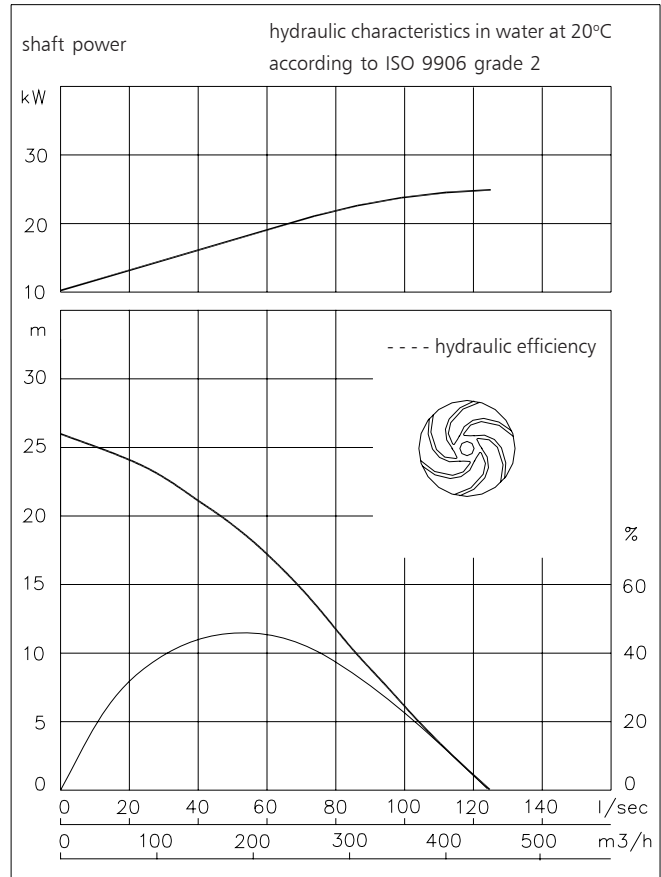

1	cast iron	EN-GJL-250
2	sg cast iron	EN-GJS-400-15
3	stainless steel 431	X20 CrNi 17 2
4	stainless steel 304	X5 CrNi 18 10
5	stainless steel 316	X5 CrNiMo 17 12 2
6	stainless steel 329	X4 CrNiMoN 27 5 2
7	Nihard 4	G-X300CrNiSi 9 5 2
8	nitrile	(NBR)
9	neoprene	(CR)
10	viton	(FPM)

[www.ittwwwalphen.com](http://www.ittwwwalphen.com)

*Engineered for life*



### Installation options

### RD6141LI

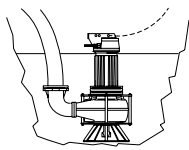

**T**

Transportable:  
With support and  
150 mm hose adapter

Without cooling system the motor is cooled by the surrounding water.  
With cooling system the motor can run continuously above the water level.

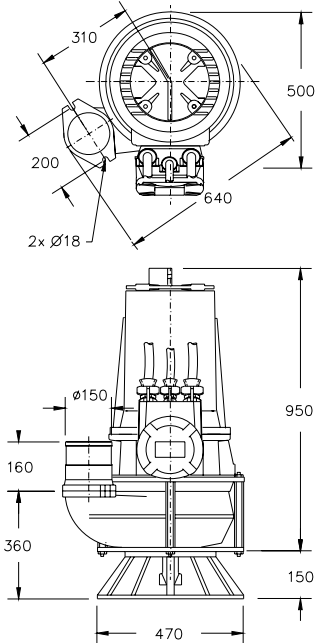

#### Version

##### **K Heavy duty version**

Standard with thermoswitches, agitator and cable connection box

##### **E Explosion proof version**

Certified according to: II 2 G Ex de IIB c T4 with 2 sets of thermoswitches.

#### Weight:

407 kg

407 kg

#### Optional:

**Cooling system** external cooling water flow min. 0.4 l/s

**Flexible protective sheathing for cable** (AISI 316)

**Water detector** in motor and oil housing (for explosion proof version only in oil housing with external cable)

### Motor connection details

voltage [V]*	rated current[A]	number of cables x number of cores x cross section [mm <sup>2</sup> ]			
		basic version		explosion proof version	
		DOL-start	YD-start	DOL-start	YD-start
380	69.8	-	2x4x10+1x4x2.5	-	2x4x16+1x4x2.5
400	66.4	1x4x16+1x4x2.5	2x4x10+1x4x2.5	1x4x16+1x4x2.5	2x4x16+1x4x2.5
415	64.0	1x4x16+1x4x2.5	2x4x10+1x4x2.5	1x4x16+1x4x2.5	2x4x16+1x4x2.5
500	53.1	1x4x16+1x4x2.5	2x4x6+1x4x2.5	1x4x16+1x4x2.5	2x4x6+1x4x2.5

starting current DOL-start : 4.5 x rated current

starting current YD-start : 1.5 x rated current

\* other voltages on request

We reserve the right to alter specifications without prior notice.