



ITT

ROBOT PUMPS

Slurry Pump

RD6141LF

60 c/s

Vortex impeller pump in wear resistant Nihard 4 for reliable transport of highly abrasive solids in high concentrations.

Pump

solids passage : 4"
 solids passage with agitator : 2"
 suction diameter : 5 3/4"
 discharge diameter : 6"
 impeller diameter : 220
 recommended minimum flow : 207 USGPM

Motor

rated horse power : 33.5 hp
 rated electrical power : 29.8 kW
 rated kVA : 36.3 kW
 mains : 60 c/s - 3 phase
 speed : 1750 rpm
 rated efficiency : 84 %
 rated power factor (cos phi) : 0.82
 degree of protection : IP 68
 isolation class : F (311 °F)
 max. water temperature : 104 °F
 (higher temperatures on request)
 standard cable length : 33 ft
 max. submersion depth : 66 ft

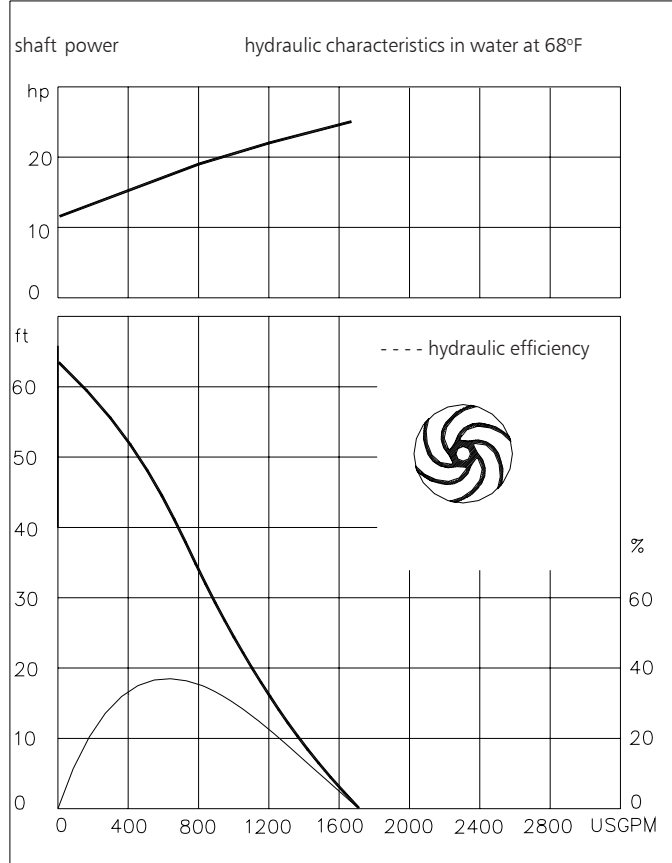

15.9 USGPM = 1 l/s 1 hp = 0.736 kW 1 ft = 0.3 m 1 lb = 0.45 kg

Materials

motor housing : 1
 seal housing : 7
 volute : 7
 hose adapter : 7
 impeller : 7
 agitator : 7
 shaft : 3 5
 bolts : 4 5
 cooling jacket : 4
 elastomers : 8+9
 electrical cable : 9
 seal lubrication : oil
 pump seal : silicon carbide-ceramic
 motor seal : carbon-ceramic
 primer : Alkyd primer
 top coating : Two component high-build polyurethane coating

| | | |
|----|-----------------|----------------------------|
| 1 | cast iron | ASTM A-48 Class 35 |
| 2 | sg cast iron | ASTM A445 Gr.60-46-18 |
| 3 | stainless steel | AISI 431 |
| 4 | stainless steel | AISI 304 |
| 5 | stainless steel | AISI 316 |
| 6 | bronze | ASTM B145 Gr. 4a |
| 7 | Nihard 4 | ASTM A532, class I, type D |
| 8 | nitrile | (NBR) |
| 9 | neoprene | (CR) |
| 10 | viton | (FPM) |

www.ittwwwalphen.com

Engineered for life



Installation options

RD6141LF

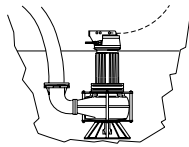

T

Transportable:
With support and
6" discharge bend
or hose adapter.

Without cooling system the motor is cooled by the surrounding water.
With cooling system the motor can run continuously above the water level.

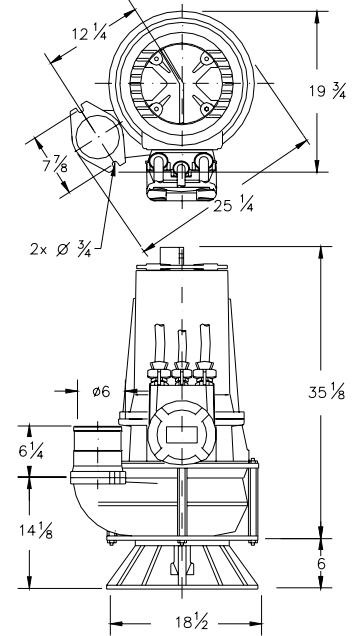

Versions

K Basic version

standard with thermostiches and agitator.

P FM approved version

Certified according to:
Class I, Division I, Groups C&D T4
Standard with thermostats and waterdetector in motorhousing.

Weight

764 lbs

764 lbs

Optional:

Cooling system external cooling water flow min. 2.4 USGPM

Flexible protective sheating for cable (AISI 316)

Water detector in motor and oil housing (for explosion proof version only in oil housing with external cable)

Motor connection details

| voltage [V]* | rated current[A] | electrical cable size | | | |
|--------------|------------------|-----------------------|---------------------|---------------------|---------------------|
| | | DOL-start | | FM approved version | |
| | | DOL-start | YD-start | DOL-start | YD-start |
| 380 | 55.1 | 2xAWG8/4+1xAWG14/4 | 2xAWG8/4+1xAWG14/4 | 2xAWG8/4+1xAWG14/7 | 2xAWG8/4+1xAWG14/7 |
| 400 | 46.1 | 2xAWG8/4+1xAWG14/4 | 2xAWG8/4+1xAWG14/4 | 2xAWG8/4+1xAWG14/7 | 2xAWG8/4+1xAWG14/7 |
| 415 | 45.6 | 2xAWG6/4+1xAWG14/4 | 2xAWG8/4+1xAWG14/4 | 2xAWG6/4+1xAWG14/7 | 2xAWG8/4+1xAWG14/7 |
| 500 | 36.4 | 2xAWG6/4+1xAWG14/4 | 2xAWG10/4+1xAWG14/4 | 2xAWG6/4+1xAWG14/7 | 2xAWG10/4+1xAWG14/7 |

starting current DOL-start

: 5.7 x rated current

* other voltages on request

starting current YD-start

: 1.9 x rated current

We reserve the right to alter specifications without prior notice.