



# ITT

## ROBOT PUMPS

### Dry installed vortex pump

### BW4021

The dry installed vortex pumps are designed to pump a wide variety of solids contaminated liquids. They are used for sewage and other waste water applications. These pumps are designed for a stationary dry installation of pump and motor.

solids passage	: 65 mm	<b>50 Hz</b>
discharge flange	: NW 80	
suction flange	: NW 80	
impeller diameter	: 178-140 mm	
recommended min. flow	: 3.5 l/s (13 m <sup>3</sup> /h)	

hydraulic characteristics in clean cold water according to ISO 9906 grade 2

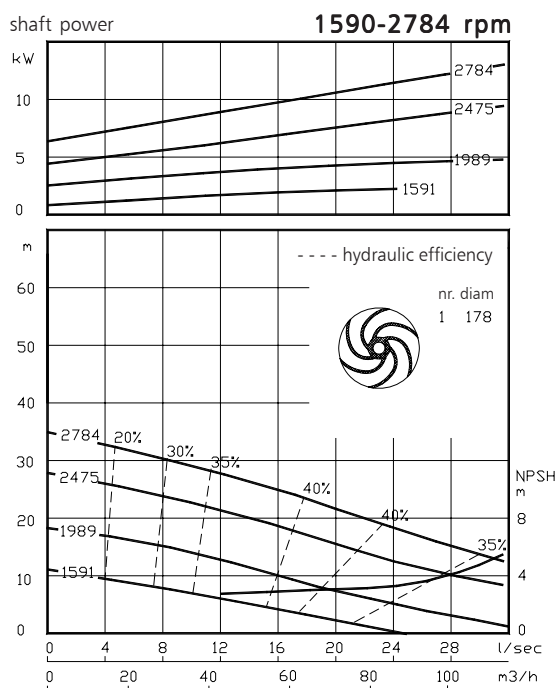
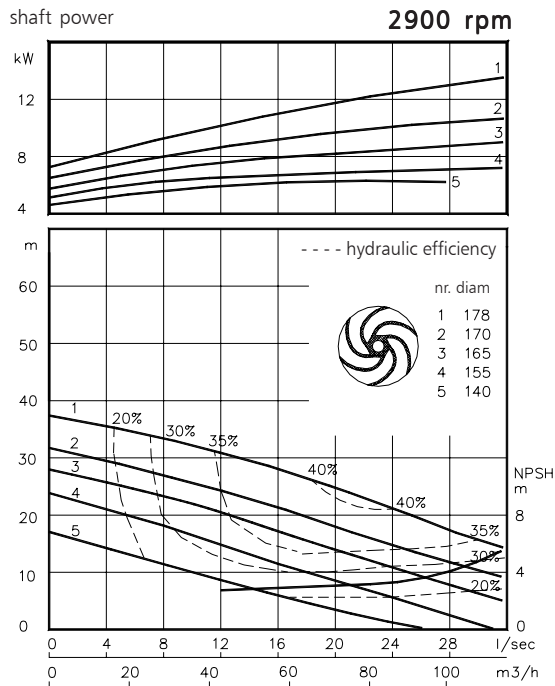

Available electric motors Degree of protection IP55		
Class	kW	[rpm]
IEC 132S	5.5	2900
	7.5	2900
IEC 160M	11.0	2900
	15.0	2900

[www.robotpumps.com](http://www.robotpumps.com)

*Engineered for life*



# ITT

## ROBOT PUMPS

### Installation options

### BW4021

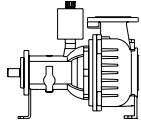

**H**

Horizontal installation:  
Bare shaft

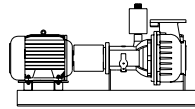

**HM**

Horizontal installation:  
With foundation plate  
and electric motor.

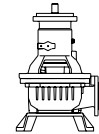

**V**

Vertical installation:  
Bare shaft

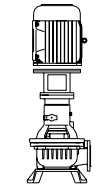

**VM**

Vertical installation:  
With support and electric  
motor.

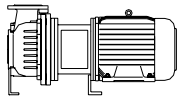

**HS**

Short coupled:  
Horizontal installation.

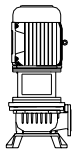

**VS**

Short coupled:  
Vertical installation.

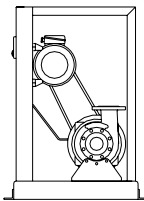

**K**

V-belt driven:  
Frame construction.  
For motors IEC100L-200L.

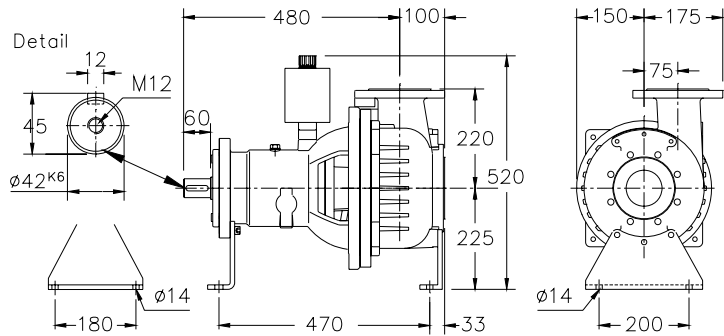

#### Flange connections

		Standard	
		DIN 2501	PN10/PN16
		p.c.d.	Number x holes
Discharge	NW 80	160	8x ø19
Suction	NW 80	160	8x M16

Weight (H version): 100 kg.

#### Optional:

- seal flushing

*Other options and materials upon request*

### Materials

sealhousing	: 1
pump casing	: 1
impeller	: 2 5 6 7
pump shaft	: 3 5
bearing housing	: 1
bolts	: 4 5
elastomer	: 8+9 10
seal lubrication	: oil
pump seal	: silicon carbide-silicon carbide
secondary seal	: carbon - ceramic
primer	: alkyd primer
top coating	: two components high-build polyurethane coating

1	cast iron	EN-GJL-250
2	sg cast iron	EN-GJS-400-15
3	stainless steel 431	X20 CrNi 17 2
4	stainless steel 304	X5 CrNi 18 10
5	stainless steel 316	X5 CrNiMo 17 12 2
6	stainless steel 329	X4 CrNiMoN 27 5 2
7	wear resistant sg iron	HB 500
8	nitrile	(NBR)
9	neoprene	(CR)
10	viton	(FPM)

We reserve the right to alter specifications without prior notice.