



ITT

ROBOT PUMPS

Dry installed stainless steel vortex pump

BW4020

The dry installed stainless steel vortex pumps are designed to pump a wide variety of solids contaminated liquids. They are used for sewage and other waste water applications. The pump can be used in aggressive applications pH = 1-13. Standard elastomers are in FPM (Viton).

solids passage : 2 1/2" **60 c/s**
 discharge flange : 3"
 suction flange : 3"
 impeller code : 225-170
 recommended minium flow : 55 USGPM

hydraulic characteristics in water at 68°F

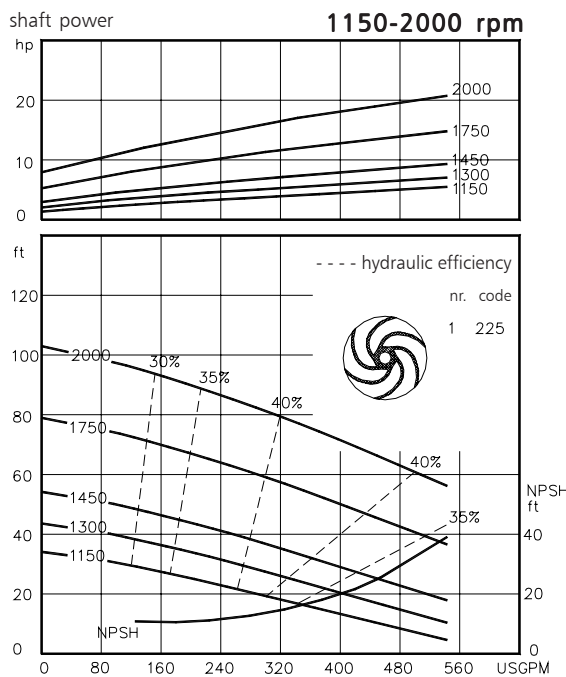
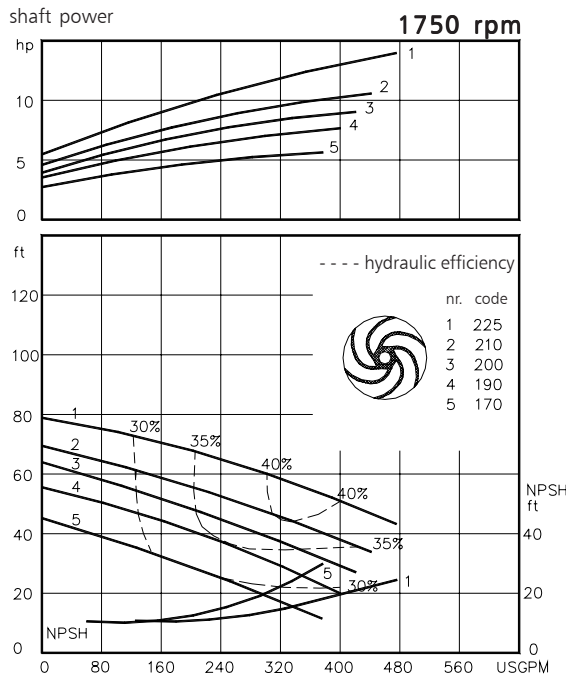

| Available electric motors Degree of protection IP55 | | |
|--|------|-------|
| NEMA | [hp] | [rpm] |
| 213T | 7.5 | 1750 |
| 215T | 10 | 1750 |
| 254T | 15 | 1750 |
| 215T | 15 | 3500 |
| 254T | 20 | 3500 |

www.ittwwwalphen.com

Engineered for life



ITT

ROBOT PUMPS

Installation options

BW4020

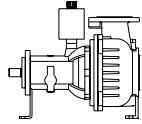

H

Horizontal installation:
Bare shaft

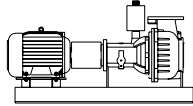

HM

Horizontal installation:
With foundation plate
and electric motor.



V

Vertical installation:
Bare shaft



VM

Vertical installation:
With support and electric
motor.

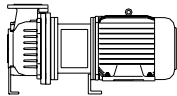

HS

Short coupled:
Horizontal installation.

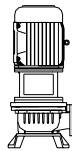

VS

Short coupled:
Vertical installation.

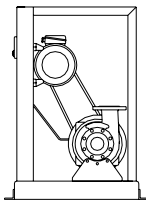

K

V-belt driven:
Frame construction.
For motors NEMA
145T - 324T.

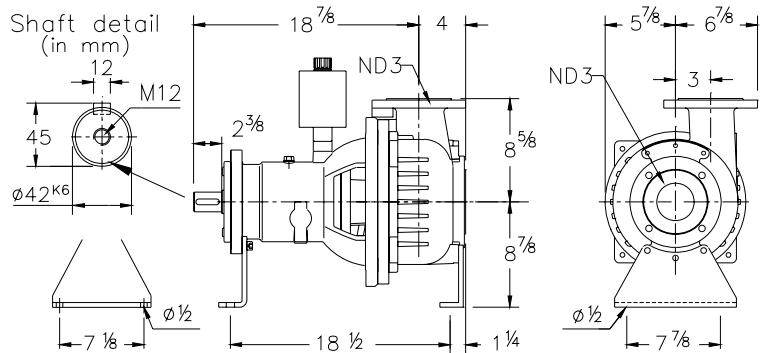

Flange connections

Standard

| | | p.c.d. | ANSI 150 Number x holes |
|-----------|------|--------|-------------------------------|
| Discharge | ND 3 | 6 | 4 x $\varnothing \frac{3}{4}$ |
| Suction | ND 3 | 6 | 4 x $\frac{5}{8}$ UNC |

Weight (H version): 220 lbs

Optional:

- seal flushing

Other options and materials upon request

Materials

| | |
|------------------|---|
| sealhousing | : 5 |
| pump casing | : 5 |
| impeller | : 5 6 |
| pump shaft | : 5 |
| bearing housing | : 1 |
| bolts | : 4+5 |
| elastomer | : 10 |
| seal lubrication | : oil |
| pump seal | : silicon carbide-silicon carbide |
| secondary seal | : carbon - ceramic |
| primer | : Alkyd primer |
| top coating | : Two component high-build polyurethane coating |

| | | |
|----|------------------------|-----------------------|
| 1 | cast iron | ASTM A-48 Cl.35 |
| 2 | sg cast iron | ASTM A445 Gr.60-46-18 |
| 3 | stainless steel | AISI 431 |
| 4 | stainless steel | AISI 304 |
| 5 | stainless steel | AISI 316 |
| 6 | stainless steel | AISI 329 |
| 7 | wear resistant sg iron | HB500 |
| 8 | nitrile | (NBR) |
| 9 | neoprene | (CR) |
| 10 | viton | (FPM) |

We reserve the right to alter specifications without prior notice.